

KEY

--- SITE BOUNDARY/LIMIT OF CONSTRUCTION WORKS

- NEW CARRIAGEWAY INCLUDING TIE-IN TO EXISTING
- CARRIAGEWAY OVERLAY
- FOOTWAY WORKS
- CONTROLLED CROSSING (RED TACTILES)
- UNCONTROLLED CROSSING (BUFF TACTILES)
- LANDSCAPE / GRASSED AREA
- HIGH FRICTION SURFACING

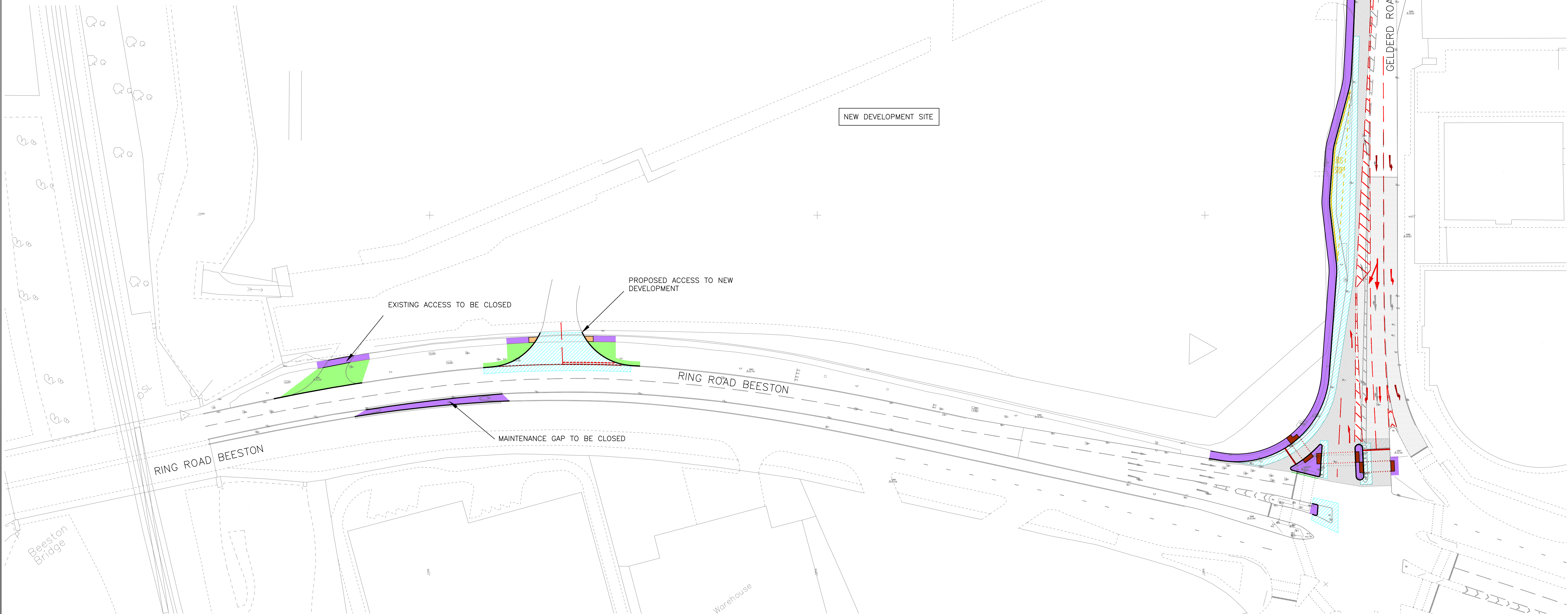

© LEEDS CITY COUNCIL
This drawing is the property of Leeds City Council. It must only be used for the purpose for which it was originally supplied. It must not be copied, published or transmitted by any means to any third party, without the express permission of the originator. Modification or manipulation of all or part of this drawing is strictly forbidden, unless specifically requested or approved by the originator.

S278 GELDERD ROAD/ RING ROAD BEESTON
GENERAL ARRANGEMENT

AMENDMENTS	DRAWN	CHECK	DATE	DRAWN BY	
FIRST APPROVED	LK			INITIALS	DATE
A. Safety Audit comments added	LK		28.11.14	LK	11/14
B. Gelderd Road Pedestrian refuge amended	LK		28.11.14	AutoCAD BY	
				INITIALS	DATE
				LK	11/14
				CHECKED BY	
				INITIALS	DATE
				RS	11/14



Leeds
CITY COUNCIL
HIGHWAYS AND TRANSPORTATION

DRAWING NUMBER:

EP/732186/MISC/02B

DATE: November 2014